

trafalgarmeetings&events

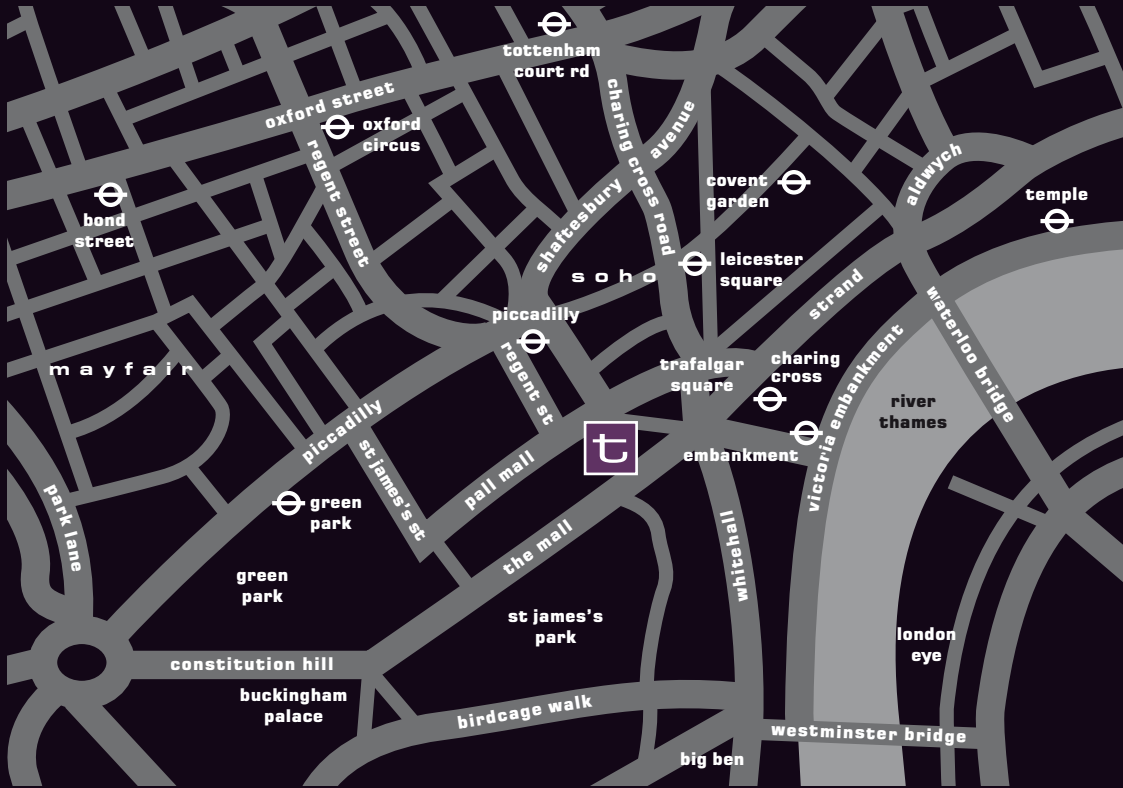

- minutes from charing cross and embankment tube stations
- good access to bakerloo line, which connects to paddington for the heathrow express
- close to the business districts of the strand, pall mall, mayfair, st james'
- taxi to the city: £10

attractions

- theatre land
- soho
- covent garden
- oxford and regent street
- big ben
- leicester square
- buckingham palace
- london eye

	page 1-2	page 3-4	page 5-6	page 7-8	page 9-10	page 11-12
	boardroom	strategy	upper rockwell	lower rockwell	roof garden	bedrooms
boardroom	20	18	n/a	n/a	n/a	n/a
u-shape	15	15	n/a	n/a	n/a	n/a
hollow square	20	20	n/a	n/a	n/a	n/a
theatre	40	30	n/a	n/a	n/a	n/a
cabaret	22	16	n/a	n/a	n/a	n/a
lunch/dinner	30	20	75	48	50	n/a
reception	50	40	150	100	50	n/a
natural daylight	yes	yes	yes	no	yes	yes
air-conditioning	yes	yes	yes	yes	n/a	yes



the boardroom was used in the ipress file, starring michael caine and james bond's dr no. it has superb views over trafilgar square and is fitted with original 1930's wood panelling combined with modern light fittings. the result is a warm atmosphere suitable for meetings, presentations, lunches, drinks, parties and dinners

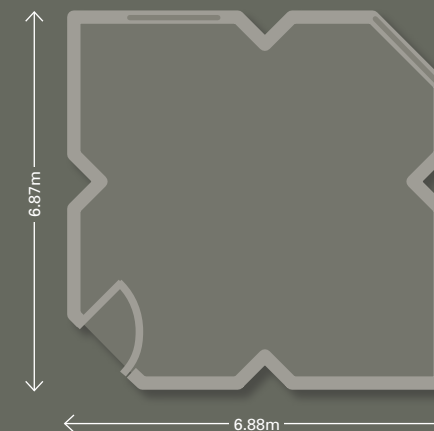

	boardroom	u-shape	hollow square	theatre	cabaret	lunch/dinner	reception	natural daylight	air-conditioning
capacities	20	15	20	40	22	30	50	yes	yes

area 47.42m²

ceiling height 4.57m

7 electrical sockets • 4 phone/isdn lines • 1 TV socket

the contemporary **strategy room** has dramatic floor-to-ceiling windows, allowing for plenty of natural light and views over **trafalgar square**. it is adjacent to the boardroom and is connected by a small foyer

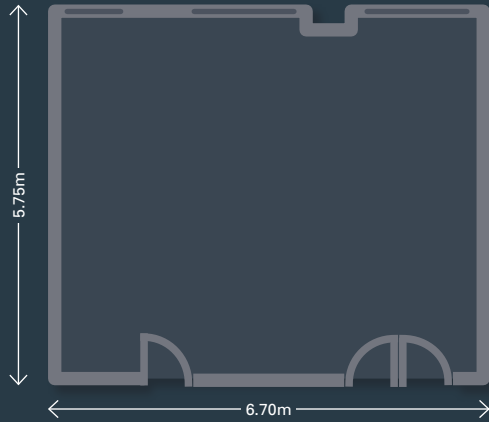

	boardroom	u-shape	hollow square	theatre	cabaret	lunch/dinner	reception	natural daylight	air-conditioning
capacities	18	15	20	30	16	20	40	yes	yes

area 38.53m²
 ceiling height 4.57m
 6 electrical sockets • 4 phone/isdn lines • 1 TV socket



rockwell! the trafilgar's award-winning bar and restaurant

split between two floors, connected by two staircases

upper rockwell. tasteful. contemporary.

sexy. a space oozing style

lower rockwell. relaxed. classy.

comfortable. exceptional room to entertain

two unique venues that work great together or just as well on their own



upper rockwell

	boardroom	u-shape	hollow square	theatre	cabaret	lunch/dinner	reception	natural daylight	air-conditioning
capacities	upper rockwell	n/a	n/a	n/a	n/a	75	150	yes	yes
	lower rockwell	n/a	n/a	n/a	n/a	48	100	n/a	yes
	combined	n/a	n/a	n/a	n/a	123	250	-	yes

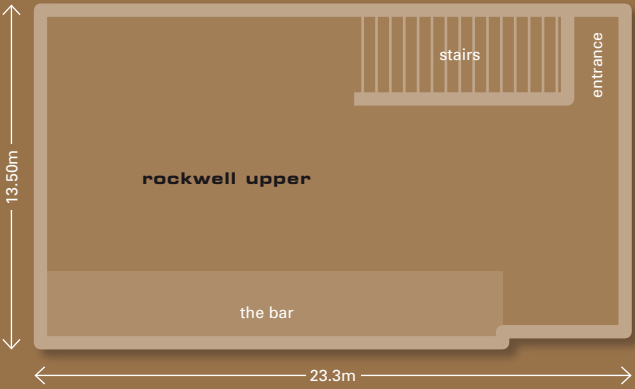

area	445m ²
ceiling height	3.5m

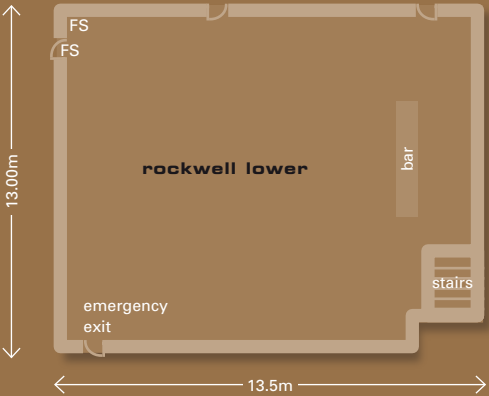

area	215m ²
ceiling height	2.95m



lower rockwell

exclusive to the trafilgar is our roof garden where you are at eye level with admiral nelson and, like him, you get the most stunning views over london, the roof garden is available for private hire

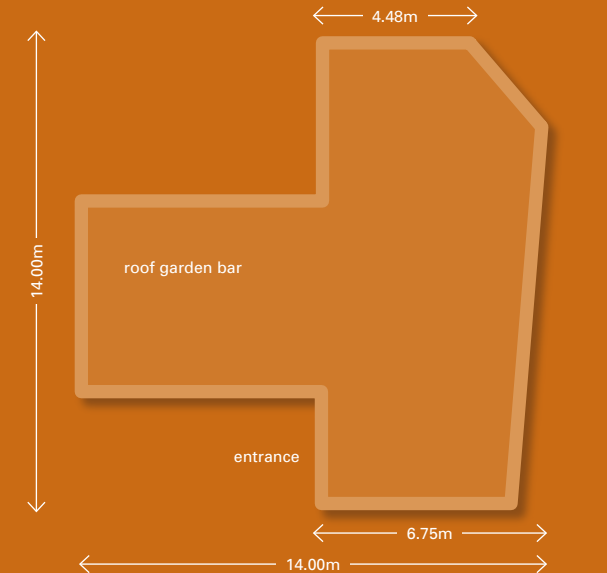

	boardroom	u-shape	hollow square	theatre	cabaret	lunch/dinner	reception	natural daylight	air-conditioning
capacities	n/a	n/a	n/a	n/a	n/a	50	50	yes	n/a

area 124m²

ceiling height the sky's the limit



high-speed internet access, dvd/cd players, 2-line telephones, voicemail, laptop safe, terrestrial & satellite tv channels, mini-bar, air-conditioning, mist-free mirrors, aromatherapy toiletries, duvets, iron and ironing board, hairdryer and a wide range of other amenities including our state-of-the-art gym

129 spacious
bedrooms
with tasteful
white and dark
chocolate tones.
caressing light.
softly illuminated
walnut furniture.
white pendular
lamps. feather
light curtains.
breathtaking
views
bubble bath tubs
with space for
two. soothing
sounds from
the stereo and
dvd system.
comfortable
armchairs and
sofas. faultless
relaxation



2 spring gardens, trafalgar square, london sw1a 2ts, england

t: +44 (0)20 7870 2900 f: +44 (0)20 7870 2911

e: sales.trafalgar@hilton.com

www.thetrafalgar.com